

WORKSHOP MANUAL

KB. UBS

SECTION 13

RADIATOR



ISUZU MOTORS LIMITED



CONTENTS

PAGE

General description13- 1
Specifications13- 2
KB gasoline engine model13- 3
Except KB gasoline engine model13- 5



GENERAL DESCRIPTION

G200Z and 4ZD1 GASOLINE MODEL

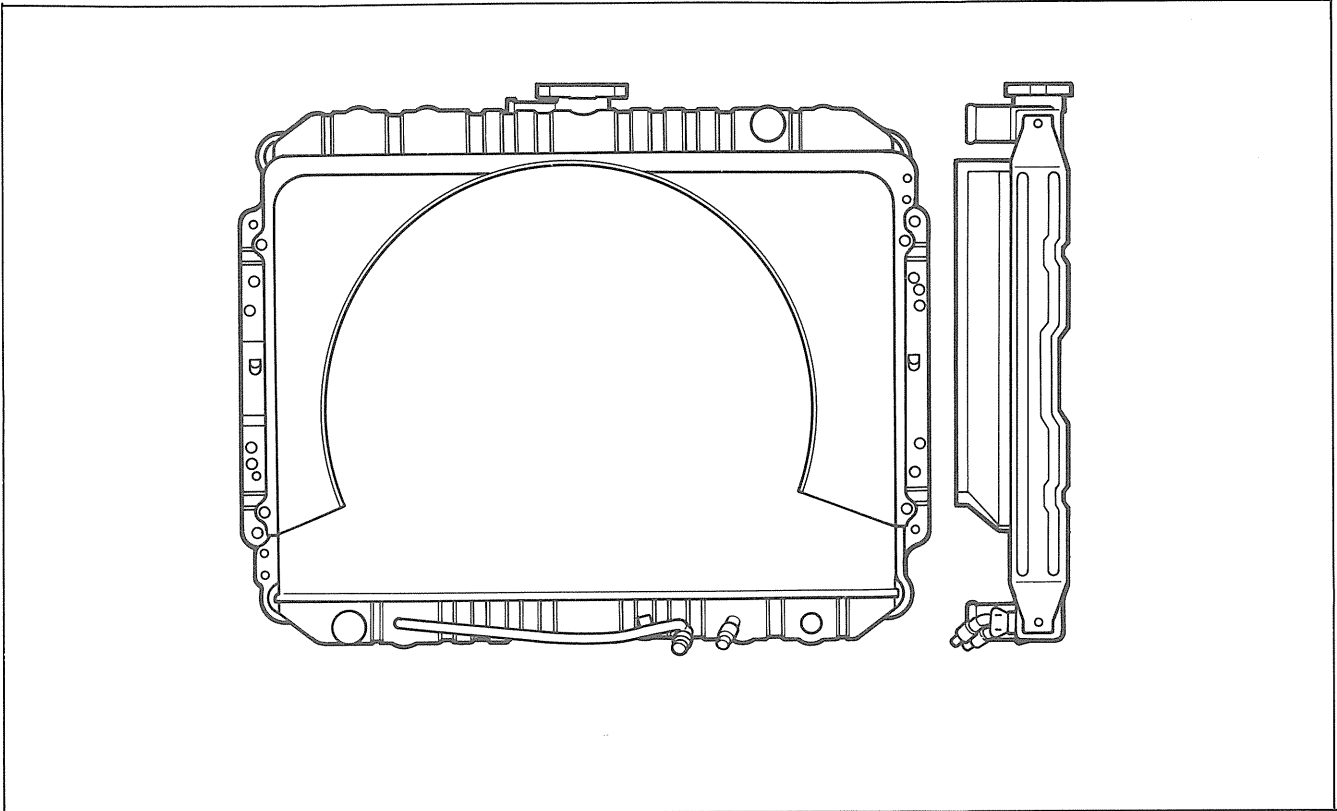

C223 DIESEL

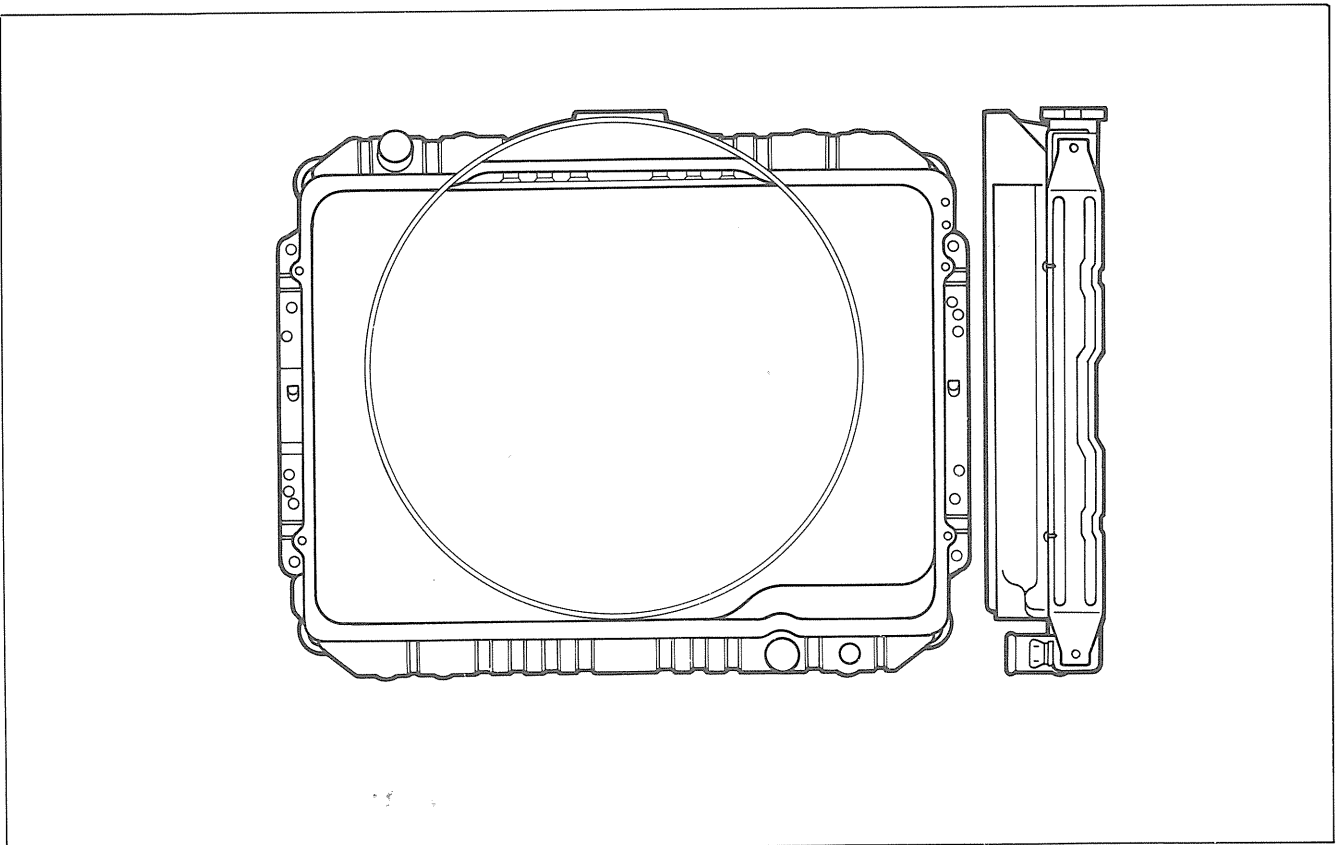

SPECIFICATIONS

Model		G161, G200Z [KB]	4ZD1 [UBS]	C190 [KBD]
Radiator core				
Height	mm (in.)	387 (15.24)	420 (16.54)	387 (15.24)
Width	mm (in.)	552.4 (21.74)	552.4 (21.74)	552.4 (21.74)
Frontal area	m ² (in. ²)	0.214 (3.32)	0.232 (3.60)	0.214 (3.32)
Relief pressure	kg/cm ² (psi)	0.9—1.2 (13—17)	0.9—1.2 (13—17)	0.9—1.2 (13—17)
Model		C223 [UBS52]	C223 [KBD]	C223T UBS52J]
Radiator core				
Height	mm (in.)	420 (16.54)	378 (14.88)	423 (16.65)
Width	mm (in.)	552.4 (21.74)	548 (21.57)	548 (21.57)
Frontal area	m ² (in. ²)	0.232 (3.60)	0.207 (3.21)	0.232 (3.60)
Relief pressure	kg/cm ² (psi)	0.9—1.2 (13—17)	0.9—1.2 (13—17)	0.9—1.2 (13—17)

KB GASOLINE ENGINE MODEL REMOVAL AND INSTALLATION

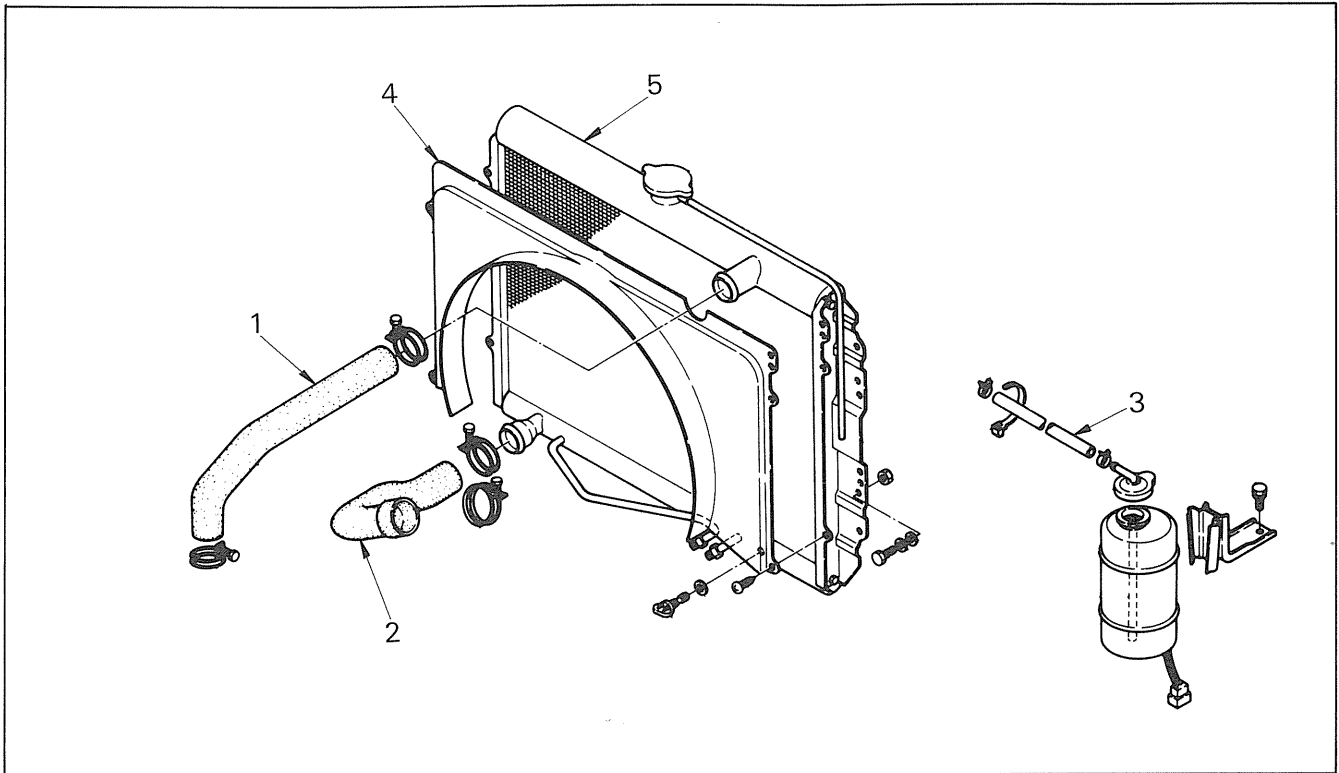
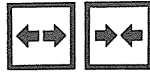

Removal steps

1. Top hose
2. Bottom hose
3. Hose ; surge tank
4. Fan shroud
5. Radiator assembly

Installation steps

To install, follow the removal procedure in reverse order.



INSPECTION AND REPAIR

Make necessary adjustments, repairs, and part replacements if wear damage, or other problems are discovered during inspection.

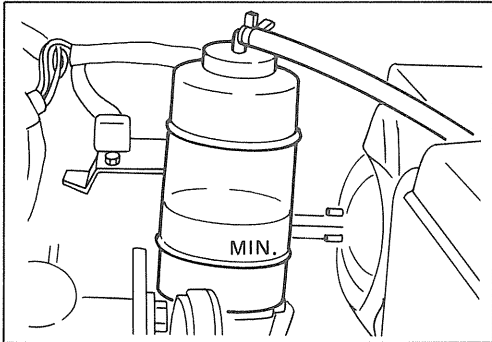

Cooling water level should be in between the maximum and the minimum level marks on the radiator reserve tank.

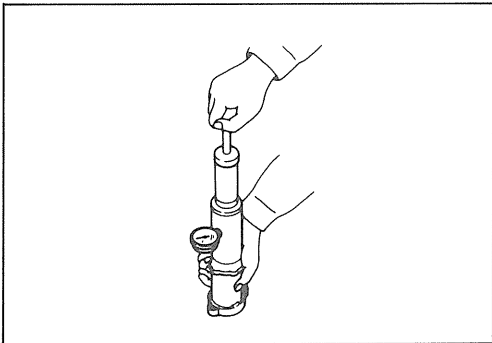

The radiator cap is designed to hold 1.05 kg/cm² (15 psi) of pressure in the cooling system. The cap may be checked using a radiator cap tester. Replacement of cap is necessary should it fail to hold pressure during test procedure.

kg/cm ² (psi)	
Pressure valve	Negative pressure valve
0.9—1.2 (13—17)	0.04—0.05 (0.6—0.7)

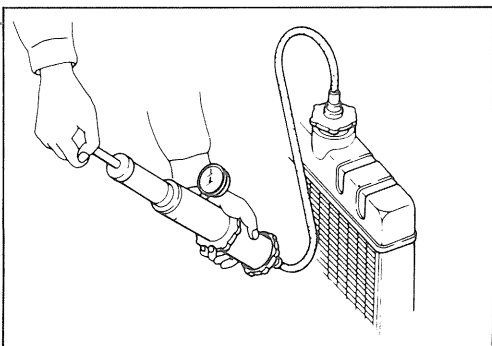

Install radiator filler cap tester on the radiator and check the cooling system for leakage by applying a test pressure.

Testing pressure should not exceed the specified pressure.

kg/cm ² (psi)	
Testing pressure	2 (28)

The cooling system should be flushed if coolant becomes contaminated or at the time of replacement. Clean water should be used to flush system until all contaminants are removed.

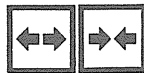
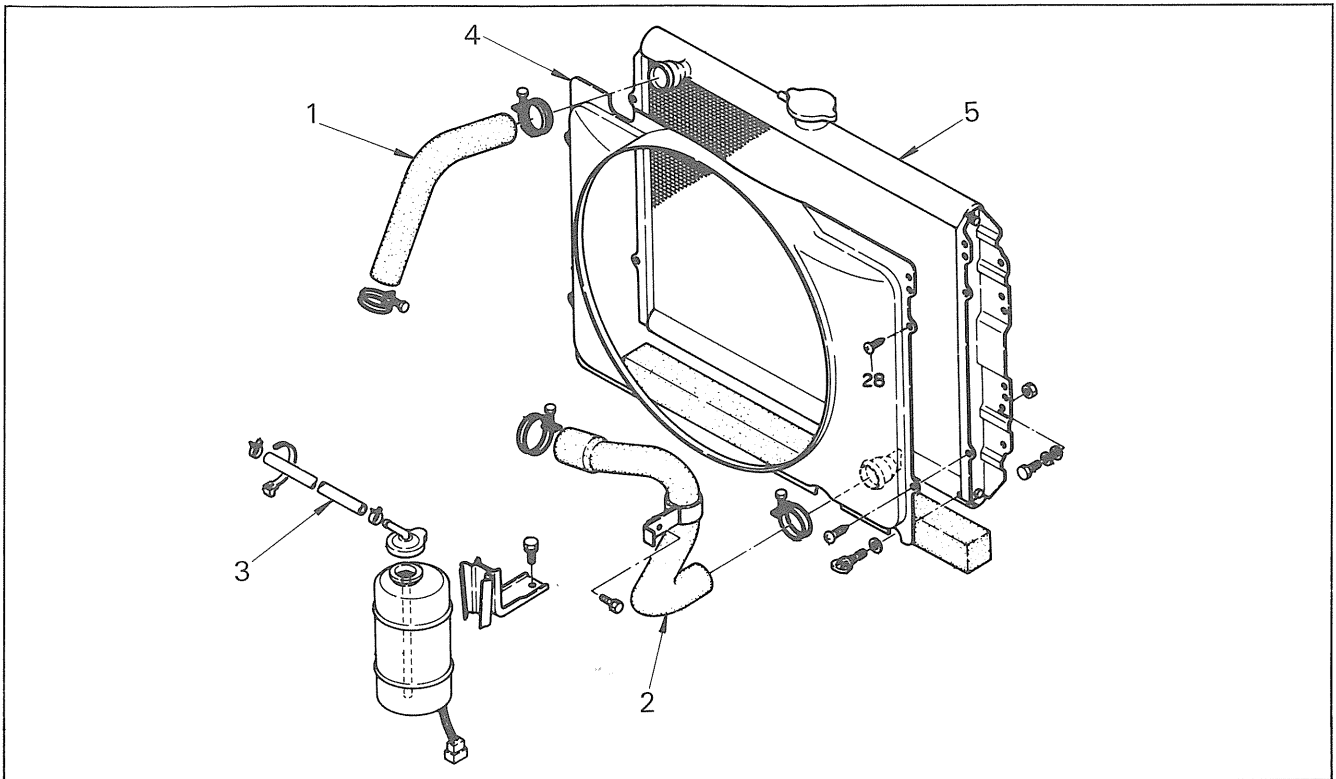
**EXCEPT KB GASOLINE
ENGINE MODEL****REMOVAL AND INSTALLATION****Removal steps**

1. Top hose
2. Bottom hose
3. Hose ; surge tank
4. Fan shroud
5. Radiator assembly

Installation steps

To install, follow the removal procedure in reverse order.



INSPECTION AND REPAIR

Make necessary adjustments, repairs, and part replacements if wear damage, or other problems are discovered during inspection.

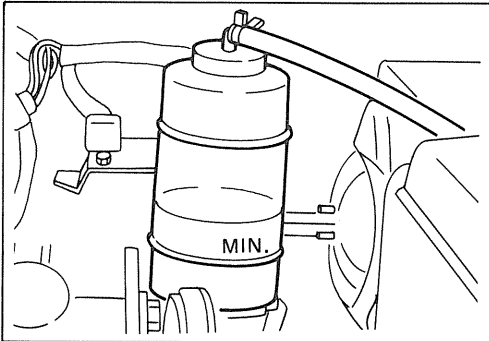

Cooling water level should be in between the maximum and the minimum level marks on the radiator reserve tank.

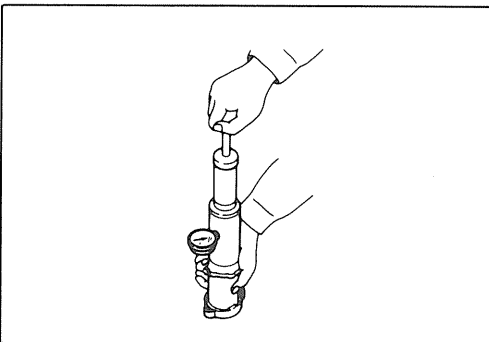

The radiator cap is designed to hold 1.05 kg/cm² (15 psi) of pressure in the cooling system. The cap may be checked using a radiator cap tester. Replacement of cap is necessary should it fail to hold pressure during test procedure.

	kg/cm ² (psi)
Pressure valve	Negative pressure valve
0.9–1.2 (13–17)	0.04–0.05 (0.6–0.7)

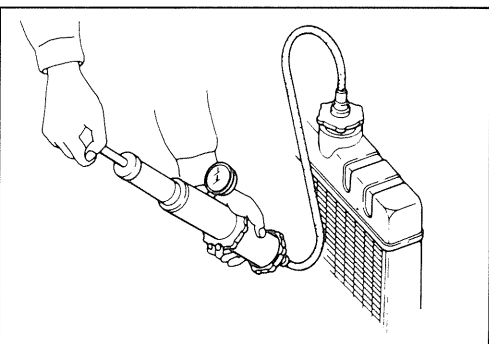

Install radiator filler cap tester on the radiator and check the cooling system for leakage by applying a test pressure. Testing pressure should not exceed the specified pressure.

	kg/cm ² (psi)
Testing pressure	2 (28)

The cooling system should be flushed if coolant becomes contaminated or at the time of replacement. Clean water should be used to flush system until all contaminants are removed.

KURAD-WE-65G

You are requested to order this manual using the manual number that is shown above.

This manual is applicable for vehicles in all countries except USA and Canada.

Copyright reserved for this manual may not be reproduced or copied, in whole or in part, without the written consent of ISUZU MOTORS LIMITED.

Issued by

ISUZU MOTORS LIMITED

OVERSEAS SERVICE DEPARTMENT

Tokyo, Japan

First edition Dec., 1985

6512-01N-13









No, KURAD-WE-65G

PRINTED IN JAPAN